

Mueller Streamline Co. Headquarters

150 Schilling Blvd
Suite 201
Collierville, Tennessee 38017
United States
Phone: 901 753 3200

Mueller Streamline Co. International

525 Okeechobee Blvd
Suite 860
West Palm Beach, FL 33401
United States
Phone: 561 273 8300

ITEM # A 16316, BRASS COMPRESSOR VALVES - FLANGE UNION, SOLDER

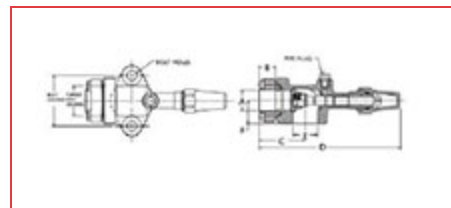

[Specifications](#) | [Dimensions](#) | [References](#) | [Torque To Seal](#)

Specifications

Connection Size	1 3/8 in
MAP	48 bar 700 psi
Valve Weight	3.65 lb 1.66 kg
Valve Kit Weight	3.80 lb 1.72 kg
Operating Temperature [Min]	-40 °C -40 °F
Operating Temperature [Max]	149 °C 300 °F

Seat Position

Front

Dimensions

A	1 3/8 in 35 mm
B	0.97 in 25 mm
C	2.47 in 63 mm
D	7.49 in 190 mm
E	1.25 in 32 mm
F	1.25 in 32 mm
Bolt Centers	2 3/4 in 70 mm
Bolt Hole Diameter	0.531 in 13 mm
Pipe Plug Size	1/8 in
Flange Thickness	1 in 25 mm

References

Valve Kit Part Number	A 17526
Body Number	A 03416
Standard Seal Cap	P 34632
Standard Seal Cap-Material	Plastic
Standard Seal Cap-Kit	P 35915
Replacement Seal Cap -Plastic	P 34632

Replacement Seal Cap-Brass	A 15099
-----------------------------------	---------

Replacement Kit	A 17419
------------------------	---------

Torque To Seal

Front Seat	30 to 40 ft·lb 41 to 54 N·m
-------------------	--------------------------------

Back Seat	22 to 45 ft·lb 30 to 61 N·m
------------------	--------------------------------

Pack Gland	15 to 25 ft·lb 20 to 34 N·m
-------------------	--------------------------------

Pipe Plug	2 - 3 Threads Exposed
------------------	-----------------------

Plastic Cap	Hand Tight
--------------------	------------

Brass Cap	40 to 50 ft·lb 54 to 68 N·m
------------------	--------------------------------